



No. 161 January 2026

## BBLA Board of

### Directors

Craig Tweedale, Pres.	608.317.6647
Kevin Costello, Treas.	480.250.3698
Matt Everding, V Pres.	320.492.5902
Jay Anderson	763.482.1926
Mark Erdmann	763.386.9254
Blake Johnson	612.910.3871
Deb Johnson	320.285.5833
Brandon Kelly	320.491.6107
Steve Konser	320.200.9419
Bill Lieder	320.733.2777
Grant Niehaus	320.583.4939
Jeanne Niehaus	651.757.7475
Gary Rothstein	320.290.7818
Steve Thelen	320.309.9881

Big Birch Lake email address:  
bigbirchlakeasso@gmail.com

Website:

[www.bigbirchlakeassociation.org](http://www.bigbirchlakeassociation.org)

The Big Birch Lake Association  
Newsletter is an official  
publication of the Big Birch Lake  
Association, Inc. PO Box 342,  
Grey Eagle, MN 563336

Craig Tweedale, President  
Robert Kutter,  
Secretary/newsletter editor

### Mission Statement

**The purpose of the Big Birch  
Lake Association shall be to  
improve and protect water  
quality, to advance the  
propagation and habitat of fish  
and to protect the welfare of all  
wildlife in Big Birch Lake and  
adjacent areas.**

## President's Letter

On behalf of the Big Birch Lake Association (BBLA) Board Members, we wish everyone a happy and healthy new year. We are very thankful we have such great members and volunteers. Without you, our lake wouldn't be as healthy as it is.

Channel/Birch Creek Outlet: For those who may not know, we have our beaver friends damming up the channel /Birch Creek Outlet between Little Birch Lake (LBL) and Big Birch Lake (BBL). As some of you may have seen, they were building their dam on the spillway that is right under the bridge.

With help from volunteers from both BBL and LBL, we managed to keep this cleaned out to the best of our ability. We also (as we have for generations), hired a trapper to help us with this problem.

Why is it important to keep this channel /Birch Creek Outlet clear? High rains and spring thaw: Without proper flow, the BBL will rise and cause high water and flooding along some shorelines causing damage and erosion which would add nutrients for aquatic vegetation growth.

Since we are on this subject, for over a year now, we are looking for some younger volunteers to help us maintain this area. The current volunteers and their families have been doing this for generations, but we are all over 70 now, and we don't have any children or grandchildren that can help us with this task. This is a great volunteer opportunity to get our younger generation involved.

It is very flexible as far as time is concerned. It just takes 1 or 2 volunteers. All one needs to do is watch or get a call that the channel/outlet is getting plugged up. Then one goes and pulls the debris from the area. This happens spring through fall.

Our current volunteers have tools and techniques they have learned over the years that they would love to pass on. Who knows, the new volunteers may even come up with a better method. So if you know anyone that is interested and wants to give it a try, please have them contact me. It would be appreciated.

Our Membership Drive is in full swing. As I previously mentioned, without your membership, we couldn't keep our lake as healthy as it is. Our dues will remain the same at \$50.00. We know many of you donate more than that. For that, we are very grateful.

By this time you should have received your membership packet in the mail. Dues and donations can be done by mail or on our website. Also watch our Facebook page for information. I would also like to encourage any of our members who have new neighbors who may not know about the BBLA, to reach out to them and invite them to the BBLA meeting in August, and also have them friend us on Facebook and check out our website at [bigbirchlakeassociation.org](http://bigbirchlakeassociation.org) where they have access to all our newsletters, etc.

Both Deb Johnson and I will again be attending the Todd County (Aquatic Invasive Species) AIS meeting this January. This will be an important meeting as they will be discussing AIS protection to lakes in Minnesota. You may be aware, the state budget program for AIS in the form of education, decontamination and inspections at the DNR landings will be cut from 8.4 million to 4.2 million. It's a very good possibility that to offset this tremendous impact in 2027, Todd County may preemptively cut their budget in half in 2026 to ease the full impact in 2027, so pacing this over two years.

**President's Letter** continues on page 2

**President's Letter** *continued from page 1*

This being said, lake associations, if they choose to, will have to fund some of the AIS inspections for those two years and future years. There is a lot to discuss and big discussions will take place by the BBLA board of Directors, as this will be a substantial cost to the association. We will have to see if these costs are sustainable over the long term.

Since we are on the topic of AIS, as many of you know, Deb Johnson will be ending her term as Director and AIS Chair in July. We are still looking for someone to chair or co-chair. Deb would like to make this an easy transition so please notify Deb or myself if you are interested in learning about this position.

For those of you who winter on the lake, stay warm. It looks like a perfect winter for all winter sports. To all you snow birds, safe travels and we shall see you in the spring.

## BBLA Financial Report for November 2025

		Nov 30, 25	Nov 30, 24
	1020 · Money Markey-CMCU	35,767.43	38,513.74
	Total Checking/Savings	231,332.56	174,049.20
	Other Current Assets		
	1080 · Initiative Foundation Fund	62,521.99	56,426.01
	1499 · Undeposited Funds	0.00	9,196.92
	Total Other Current Assets	62,521.99	65,622.93
	Total Current Assets	293,854.55	239,672.13
	Fixed Assets		
	1200 · Building & Land	0.00	35,300.00
	Total Fixed Assets	0.00	35,300.00
	<b>TOTAL ASSETS</b>	<b>293,854.55</b>	<b>274,972.13</b>
	<b>LIABILITIES &amp; EQUITY</b>		
	Liabilities		
	Long Term Liabilities		
	2550 · Reserve		
	2551 · Aquatic-Invasive Species	100,000.00	100,000.00
	2552 · Future Buffer Strips	14,495.72	14,495.72
	Total 2550 · Reserve	114,495.72	114,495.72
	Total Long Term Liabilities	114,495.72	114,495.72
	Total Liabilities	114,495.72	114,495.72
	Equity		
	3990 · Unrestricted Net Assets	169,747.32	162,344.94
	Net Income	9,611.51	-1,868.53
	Total Equity	179,358.83	160,476.41
	<b>TOTAL LIABILITIES &amp; EQUITY</b>	<b>293,854.55</b>	<b>274,972.13</b>

## Obituary of lake resident

James "Jim" Loehr, 76, of Grey Eagle died unexpectedly on Sunday, October 19, 2025 at St. Cloud Hospital in St. Cloud, Minnesota.

Jim was born in Melrose to Sophia (Schanhaar) and August Loehr. He enjoyed hunting, fishing, and spending time at Big Birch Lake with his friends and family. Jim graduated from Melrose High School in 1967 and went on to play football at NDSU. From 1970 to 1972 he served in the US Army and returned to attend St. Cloud State University where he met the love of his life Renee Johnston.

After college Jim worked in the natural gas pipeline industry eventually becoming a Regional Manager for NPL where he worked until his retirement. He will be remembered by his colleagues for his mentorship and exceptional leadership. He lived his life by the core values of his company and dedicated many years to its success. Through his work with NPL, he and Renee were able to live in some very special places in the US and Canada. Of course, these usually included world class fishing. After all, Jim always had a plan.

When Jim retired, they moved to the home they built on Big Birch Lake. Jim was a great storyteller and did he have some stories to tell. Friends were always welcome to join him as he sat on his favorite log bench outside his garage with tales of his adventures. Jim loved music and always had the radio playing in the background. He taught himself to carve totem poles and used his skills to craft wooden signs. Jim enjoyed golfing, pheasant hunting and spending time at deer camp with his family and friends, but his real passion was fishing. He spent many hours on his boat both on Big Birch and Lake of the Woods. Winter would find him in his fish house with a friend or two, or on his way to Mexico with Renee to fish the Sea of Cortez.

**Loehr obituary** *continues on page 6*





## Kutter's Kolumn

The platt map below is from 1925 and shows ownership of land along the shores of Big Birch Lake that resides in Todd County.

Very few people owned the land adjacent to Big Birch Lake and surprising to me was the number of parcels owned by women.

The north shore land was owned by R.H. Sliter. This is the farm land that my parents eventually purchased in 1957.

The west shore of the upper bay was owned by Albert Young. A piece of that land was donated by Elizabeth, wife of Alexander Young, for Lakeview Cemetery.

Other property on the west shore was owned by A.E. Baird, and Charles Grieb,

which included Sandy Beach. The Cedar Beach land was owned by the Wilke Brothers, who were bankers in Grey Eagle at that time.

Thomas Miller owned the land north across the road from the Rock Tavern.

On the east side of the upper bay, Minnie Lambrecht owned the farm land and the land on which the Rock sits.

Moving south along the east shore, M. O. Meldaus and E. Schultz owned the land nearly to Adley Creek. One Schultz decendent owns lakeshore there today.

# Property ownership 100 years ago

## A public school near lake established in 1910

Heading south, the next parcel was farmland which belonged to the Fuller family. My grandfather, Louis Kutter, purchased the land in 1919 as a retirement home. If you look closely at the map at that point, you will see school 150.

Citizens of Grey Eagle Township petitioned Todd County to establish a school district there in 1910.

As a kid I remember exploring the building with my cousins. I can still picture the sight of a broken down pump organ. The building is long gone, but the clearing where it stood is still visible on my cousin's land.

My dad attended school there through the 8<sup>th</sup> grade, and that is where his formal education ended.

To my knowledge, District 150 was the only school close to BBL. There was an effort to establish a school on the North Shore. In fact, a log school house was erected but no district was formed and the building was later used as a church.

There were several female teachers who taught at District 150 including my Aunt Hazel Peschel.

One teacher did not return after some young rascals locked her in the basement where she went to tend the wood fire.

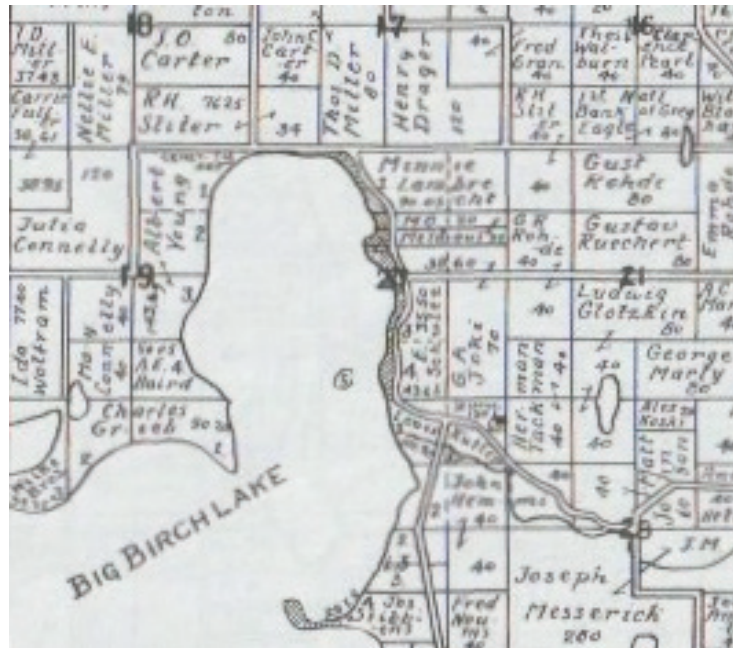

The petition was granted and the Common School District No. 150 was established. From the beginning, it consistently showed high enrollment from 30 to 60 pupils each year. Some years it had the highest enrollment of all rural districts in Todd County.

The school was also known as the Finlander School due to the number Finish immigrants who lived along the east side of the lake. John Hemmi, Nils Niska and Mike Meldaus served on the first school board as evidence of the Finnish influence. The school closed in the 1940s and the district was consolidated with the school in Grey Eagle.

Further south along the shore, land was owned by F. E. Turner, John Hemmi and Joseph Stibbens.

The Turners later established Turners' Resort later known as the Nestle Inn Resort. They also built a cabin on what is now known as Hammarsten Island. The cabin burned down in 1927.

From one point in time, it is easy to see how much land ownership around the lake has changed in the past 100 years.

We humans are conscious that change is a constant, and still heaven seems closer in a house beside the water.

# MEMBERSHIP AS OF JANUARY 2026

Althaus, Kurt & Lori	Freeman, Dave & Sue	Larson, Maxwell & Brenda	Schlough, Thomas & Joyce
Anderson, Chadyienne	Frerichs Frank, Jane	Lemieux, BJ & Rachel	Schmid, Judith
Anderson, Jay	Froehling, Joseph	Lesetmoe, Orlin & Aprile Barton	Schmid, Ted & Julie
Anderson, Jean	Fuchs, Brian & Lori	Lieder, William & Renee	Schmidt, Jane
Anderson, Stephen & Lisa	Gagne, Bob & Christine	Lilligren, Kirk & Cathy	Schmidt, Thomas & Joann
Arulfo, Michael & Michelle	Gallagher, Pat & Caryn	Linn, Mike	Schnettler, John & Jan
Atkinson, Dan & Jan	Gangl, Dale	Loehr, Jim & Renee	Schnettler, Mike & Deb
Atwood, Duane & Jody	Gasow, Ralph & Lori	Logan, Guy & Suzanne	Schwantes, Mike & Amy
Auger, John & Karen	Gerads, Dale & Mary Lou	Mack, Murray & Sue	Schwartz, Dick & Ellen
Austing, Dick & Jane	Gerding, Dewayne & Alvina	Maeder, Niklas & Brandee	Schwartz, Steve & Joann
Beckermann, Fran & Linda	Gerner, Robert & Charlene	Malm, Scott & Ann	Schwieters, Charles & Beatrice
Beehler, Robyn & Roxanne Olsen	Giles, Henry	Marshall, Karin	Seitzer, Jim & Belinda
Beekhuizen, Steven & Julie	Gordon, Brian & Kirsten	McConnell, David & Ann	Sexton Family Cabin
Benning, Ken & Mary Pat	Grossman, Jan	McQueen, Kathy	Shafer, Tom & Bonnie
Benolken, Sue	Grutsch, John & Jan	Mehr, Mike & Lori	Sieben, Kevin & Beth
Berg, Dwaine & Louise	Hatton, Rene & LuAnn	Mehr, Ralph & Mary Ann	Sieben, Russell & Mary
Berg, Ken & Bev	Heinen, Nancy	Meyer, Barry & Denise Langer	Sieloff, Justin & Sarah
Bergmann, Ken & Marilyn	Helget, Ron & Becky	Meyer, Glenn & Dianne	Silbernagel, John & Marie
Bergquist, Randy & Missy	Hendrickson, David & Colette	Meyer, Ken & Sherry	Sinclair, James & Carolyn
Bertram, Steve & Pam	Hennemann, Kitty	Meyer, Virg & Joyce	Sinclair, Ken & Jan
Beuning, James & Judine	Hinman, John & Kathy	Miley, Rod & Nancy	Smith, Patrick & Susette
Blommel, Leroy & Marilyn	Hinnenkamp, Ben & Pam	Mische, Hans & Julie	Spanier, Eric & Jana
Blommel Family	Hoeschen, Larry & Elaine	Moening, Lee & Judy	Spears (Moening), Heather
Bohlig, Bob & June	Hoffman, Dan & Janell	Mohr, Marilyn	Spence, Jim & Christine
Bonacci, Dereck	Hotzler, Mark & Jane	Mohs, Dean & Sandy	Stalboerger Family, Lorraine
Bondhus, Adam	Howe, Michael	Molitor, Chick & Karen	Starfield, Glenn
Borgerding, Clarence	Howieson, Kyle & Stacy	Molitor, Jon	Steinbring, John & Sandy
Brandt Family	Hughes, Bob & Sally	Mueller, Jerry	Stomberg, Chuck & Nancy
Brattensborg, Ruth	Hughes, Dan & Liz	Nathe, Julie	Strack, Bob & Laurie
Brixius, Bernie & Lisa	Hughes, John & Susan	Nathe, Mark & Ann	Studniski, Adam & Jolene
Broman, Brad & Charlene	Hughes, Parry & Kathy	Nelson, Chris	Tanner, Lucy
Brunner, Paul & Lauri	Humbert, Rick & Lois	Neville, Steve	Taylor, Dennis & Trish
Bruyere, James Jr	Humbert, Ryan & Stacy	Niehaus, Anthony & Carol	Tembrock, Henry
Bruyere, Scott	Ingold, Kirk & Mandi	Niehaus, Bob & Deb	Thelen, Hunter
Bueckers, Ervin	Ingold, Linnea	Niehaus, Grant	Thelen, Steve & Amy
Bullock, Lou & Debbie	Iverson, Ron & Jennifer	Niehaus, Jeanne	Thompson, Rod & Sally
Bushman, Wayne	Jacobs, Dave & Diane	Niehaus, John & Mary	Timmermann, John
Bussmann Properties LLC	Janak, Roger & Julie	Niehaus, Mitchel & Erin	Tomsche, David & Molly
Butte, Rick	Jansen, Jeff & Teri	Nohner, Kevin & Mary	Tomsche, Dr. Ed & Theresa
Campbell, Mel & Sherry	Jepperson, Craig & Mary	Olmscheid, Curt	Trierweiler, Corey & Julie
Carpenter, Todd & Laura	Johnson, Adrian & Kay	Orth, David & Linda	Tschida, Amy
Caspers, John & Allyson	Johnson, Craig & Debra	Ostendorf, Mark & Lisa	Tweedale, Craig & Mary Lou
Cavello, Butch & Amy	Johnson, Dan & Julie	Ostrem, Justin & Amy	Uphoff, Jim & Lee
Cebuhar, Mary	Kadri, Abdu & Janice	Pakola, Howard & Barb	Van Beck, Chad & Brenda
Chirhart, Penny	Kalgren, Rick & Ann	Pavlivek, John & Kathryn	VanDrehle, Donald & Helen
Citrowske, Cheri	Kappes, Mike & Jannie	Pelo, Rod & Phyllis	Vener, John
Collins, Jim & Crystal	Kaufman, Robert & Josephine	Peterson, Dr Thomas & Virginia	Vener, Mike & Kim
Collins, Joyce	Kelly, Brandon & Becky	Phillips, Rosemary	Viere, Kevin & Ann
Collins, Margaret	Kemper, Jeff & Linda	Piersak, Thomas & Jeffrey	Voigt, Kenneth & Joan Zirbes-Voigt
Costello, Kevin & Ann	Kerfeld, Cheryl	Plombon, Roger & Gloria	Volk, Randy
Damrow, Paul & June	Kerfeld, Donald & Diane	Poganski, Rock & Marcia	Von Wahlde, Cody & Denea
Davis, Scott & Marjo	Kerfeld, Glenn	Provinzino, Chuck & Jannine	Von Wahlde, Dan & Brenda
DBW Family LLC	Klaphake, Deb	Rahn, Dave & Lisa	Vowles, William & Dawn
Denne, Marv & Mary Beth	Klaphake, Florian & Doreen	Ramler, Chris & Amy	Waldvogel, Dennis
Dickhaus, Bob & Kris	Klasen, Kyle	Rasmussen, Steve & Sandy	Walker, Tom
Dinndorf, Don & Vi	Klasen, Vern & Marlene	Refsland, Curt & Mary	Walters, George & Sue
Dobesh, Jeff & Jill	Klimpel, Shawn & Chris	Richardson, David & Anna	Ward, Rick & Missy
Dougherty, Tim	Klocker, Barbara	Rieger, Joel & Pamela	Weber, Thomas
Dubiel, Marvin & Pam	Kloos, Mike & Becky	Rieland, Chuck & Lucy	Wehlage, Mike & Julie
Dufner, Randy & Hallie	Kluempke, Cathy	Rieland, Mary	Weinman, Roger & Constance
Duncomb, Bruce & Vicki	Koch, Bob & Connie	Rieland, Matt & Shari	Weitzel, Michele
Econ-O-Wash Laundromats	Kohorst, Don & Loni, Bob & Joan	Rieland, Roger & Pamela	Welle, Larry & Rose
Eiben, Joe	Konsor, Stephen & Karen	Rieland, Shirley	Westbrock, Bruce & Linda
Elfering Cabin LLC	Kotsmith, Randy & Karen	Roe, John & Janet	Worms, Steven & Shirley
Elieff, Daniel & Julie	Kotsmith, Sharon	Rothstein, Gary & Ruth	Zaborski, Tom & Julia
Enneking, Gene & Cheryl	Kuehne, Ron & Midge	Roy, Robert & Barbara	Zachman, Jeff & Linda
Erdmann, Mark & Summer	Kuhlmann, Mary	Rudolph, Jerry & Deb	Zackoski, Michael & Kimberly
Erickson, Russell	Kunkel, Phil & Rose	Russell, Jim & Mindy	Zaczkowski, Marie
Ersland, Mary Kay	Kutter, Lee & Gay	Rutherford, Peter & Lourel	Zehrer, Bill & Pam
Everding, Matt & Missy Kotzer	Kutter, Robert & Nancy	Sadlowsky, Mike & Vicki	Zenzen, Art & Marilyn
Eveslage, Steve & Sarah	Kutter, Wayne & Sherry	Sand, Daniel & Mary	Zimmer, Chris & Sarah
Falk, Jeremy & Jennifer	Kyllo, Carole	Savage, William & Sharon	Zimmerman, Lowell & Kris
First, Pete & Nicole	Lafayette Resort	Schanhaar, Tom & Deb	
Flaws, Michael & Marilyn	Larson, Brendan & Debi	Schiemann, Chuck & Ellie	
Fox, Thomas & Laurie	Larson, Gayle & Karen Lemons	Schlangen, Brad & Angie	



# SPONSORSHIP AS OF JUNE 25<sup>TH</sup> 2025



## PLATINUM

Prime Source Printing	Grey Eagle
Magnifi Financial - GE	Grey Eagle
Eagle Dock & Lift LLC	Grey Eagle
Opatz Metals & Rolloffs	Holdingford
Freeport State Bank	Melrose
Warrior Boats Inc	Melrose



## GOLD

Rahns Oil & Propane	Melrose
Bitz Plumbing & Heating Services LLC	Sauk Centre
Oaks Tree Service	Sauk Centre



## SILVER

Atkinson Well Drilling LLC	Freeport
Kelly, Brandon & Becky	Grey Eagle
Double R Saloon Inc	Grey Eagle
Guy Waymore's Musc Emporium	Grey Eagle
Lake Country Storage LLC	Melrose
Kraemer Lumber Co Inc	Melrose
Meadowlark Country Club	Melrose
Munson Feed Co Inc	Melrose
Melrose Plumbing & Heating Services Inc	Melrose
Boomerang Outdoor Recreation Inc	Melrose
Minnesota National Bank	Sauk Centre
DK's Tree & Landscaping LLC	Swanville



## BRONZE

North Risk Partners	Albany
Arnzen Construction Inc	Freeport
Hennen Floor Covering Inc	Freeport
Hennen Lumber Co Inc	Freeport
St. Rosa Lumber Inc	Freeport
Freeport Gas & Grocery-Sinclair	Freeport
Grey Eagle Electric Inc	Grey Eagle
Hinman Lawn Service	Grey Eagle
Nancy's Bait & Tackle	Grey Eagle
Update Buiding Supplies, LLC	Grey Eagle
Grey Eagle Gas & Grocery-Sinclair	Grey Eagle
Ecowater Systems of Long Prairie	Long Prairie
Dan Schmidt Printing Inc	Melrose
Engelmeyer Land Services LLC	Melrose
Mayers Inc	Melrose
Melrose 1 Stop-Sinclair	Melrose
Twin Pines Catering	Melrose

THANKS TO OUR CORPORATE SPONSORS [bigbirchlakeassociation.org](http://bigbirchlakeassociation.org)

Loehr obituary continued from page 2

Jim will be remembered by those who knew him for his generous spirit and energetic love of life. He was preceded in death by his parents "Gus" and Sophia, and survived by his wife, Renee and his "pretty good" hunting dog Roscoe.

A Celebration of Life is being planned for the Spring.



## BBLA MEMBERSHIP 2026

YOU CAN NOW GO ON LINE TO MAKE YOUR DONATION.

**[bigbirchlakeassociation.org](http://bigbirchlakeassociation.org)**

Please provide your current email and mailing address, so we can contact you with Lake updates and announcements.

Name: \_\_\_\_\_

Address: \_\_\_\_\_

Email: \_\_\_\_\_

☐ New address since 2025

### MEMBERSHIP DUES

☐ Minimum Dues .....\$50

☐ Big Lake Donation .....\$100

☐ Donations above \$100 .....\_\_\_\_\_

PO Box 342 | Grey Eagle, Minnesota 56336 | [bbla@metel.net](mailto:bbla@metel.net)

## Thanks to the AIS access plant "Checkers"-2025

By Deb Johnson

All the access plant-checking teams deserve a big "Thank You" for all their work this past summer. Big Birch Lake's five accesses were examined 27 times for invasive weeds last season. The good news is that no new invasive species were found!

Unfortunately, the Starry Stonewort threat in Minnesota has become even greater. As you probably know, Starry Stonewort (SSW) is an extremely invasive algae that can take over a whole lake, spreading throughout the lake by killing or outcompeting its native vegetation. Starry Stonewort was discovered in four new MN lakes this summer. The closest one is Two Rivers Lake near Holdingford in Stearns County. In the past decade, SSW has spread from one MN lake to 35 lakes, and it has never been eradicated from any MN lake.

That makes the job of the BBL access plant-checking volunteers and the Todd County boat inspectors even more crucial. Starry Stonewort must be stopped at the access from entering BBL, or if it starts to grow here, it must be discovered early before it spreads further in the lake. Many of the twenty BBL plant-checkers have volunteered for this program for eight years. They all deserve our appreciation and thanks!

## Renew your BBLA membership

You should have received a mailer in December to encourage you to renew your membership to the BBLA for 2026.

Please provide your current email address and mailing address so the membership secretary has an up-to-date record.

The dues remain the same as last year at \$50. Of course, you can give more than that, as many of you do. Since the organization is a non-profit registered with the state of Minnesota, gifts are tax deductible.

You can always go online to the website [bigbirchlakeassociation.org](http://bigbirchlakeassociation.org) to renew your membership.

On the back page of this newsletter is a list of volunteer opportunities. Is there some way you want to give of your time and talent to serve the organization? If so, please contact the BBLA President, Craig Tweedale or any of the directors. The directors names and phone number are listed on the front page of the newsletter.

## BBLA By-laws on membership

### Article II. Membership and Dues

Section 1. Any person or organization that is interested in overall welfare of Big Birch Lake shall be eligible for membership in this Association.

Section 2. The annual dues of this Association shall be proposed by the Board of Directors and approved or revised by the voting membership, and are payable at the beginning of each calendar year. The fiscal year is from July 1 through June 30.

Section 3. All persons, in applying for membership, agree to pay all dues and assessments provided for in the By-Laws of the Association.

### Article III. Meetings

Section 1. A minimum of one (1) meeting shall be held for the general membership during each year.

Section 2. A general membership meeting shall be held on a date between Memorial Day and Labor Day.

Section 3. Special meetings of the Association or of the Board of Directors shall be held at the call of the President or by the majority vote of the Board of Directors.

**Membership By-laws continued on page 7**





**A winter wonderland has blanketed the Big Birch Lake area for much of December and into January. It is easier to appreciate the four seasons when the coldest season reveals its unique beauty. Photo by Mary Lou Tweedale.**



**Ice fishing fans at the end of December came with trucks towing fish houses. The thicker the ice, the bigger the house. Ice was reported at 10 to 14 inches by the end of 2025. Photo by Robert Kutter**



**The beauty of sun rising over Big Birch Lake in December is awesome. The colors reflected on the surface of the ice are surprising from day to day. Photos by Robert Kutter**

**Membership By-laws** *continued from page 6*

A quorum at a general membership meeting shall consist of one-tenth of the total voting membership and is required to conduct Association business at any duly called meeting. Section 5. A quorum at a Board of Directors meeting shall consist of one-third or more of the total number of elected or appointed directors of this Association and is required to

conduct any Association business at a duly called Board of Directors meeting.

**Article IV. Board of Directors and Elections**

Section 1. The Board of Directors shall have full governing power of the Association,

Section 2. Fifteen (15) directors shall be members elected from the general membership.

Section 3. To be elected, payment of dues must be current. Only members who own property adjoining the lake, or their spouses or children, or property that is owned for their benefit (e.g., in Trust) adjoining the lake may be elected. There can be only one (1) Director per membership or parcel that has a residence.

Section 4. Election of Directors shall be at the General Membership Meeting.

BIG BIRCH LAKE ASSOCIATION, INC.  
PO BOX 342  
GREY EAGLE, MN 56336

PRSR STD  
U.S. POSTAGE  
**PAID**  
PHOENIX, AZ  
PERMIT NO. 1962

---

## Volunteer activities and volunteer opportunities for the Big Birch Lake Association

If you would like to volunteer for the Big Birch Lake Association, there are many opportunities listed below. Contact the president or one of the directors and tell them what you would like to do. If you want to understand what the association does, also look at the list below. Contact information for board members is listed on page 1.

Maintain and place loon platforms  
Conduct loon survey  
Check accesses for Aquatic Invasive Species  
twice per month (AIS)  
Identify AIS and report  
Train volunteers for AIS  
Collect and test water samples at inlets  
Walleye stocking fundraiser  
Annual golf outing  
Annual ladies' brunch  
Volunteer appreciation dinner  
Prepare and conduct Annual BBLA Meeting  
Spring education day  
(Joint effort with Little Birch association. )  
Clean spillway between Big and Little Birch

Maintain Adley Creek channel between the lakes  
Remove beaver dams/hire trapper  
Update list of volunteers and boats available for emergencies  
on the lake  
Plan for AED options around the lake  
Update and negotiate buffer zones with area farmers  
Ditch and trash cleanup every spring  
Winter lake trash cleanup  
Watershed district meetings  
Board meetings April-September  
Prepare financial reports  
Maintain and update Facebook page  
Maintain and update webpage  
Prepare and mail membership materials  
Answer property owners questions